

TENANT LEGEND		
SUITE	TENANT	SF
1	WEST COAST DENTAL	1624 sf
29	7-ELEVEN	2459 sf
2	CHECK N GO	1232 sf
3	PRO NAILS	664 sf
4	HOUSE OF BRIDES	1632 sf
5		796 sf
6	SHISEN RAMEN	901 sf
7	BON ACUPUNTURE	842 sf
9	WET N' SOAK CLEANERS	842 sf
10		850 sf
11		1295 sf
12	GLOBAL BUILDING SUPPLY	1873 sf
14	SEI-KO-EN RESTAURANT	968 sf
15	MODERN TECH	665 sf
16		1228 sf
32	SPIRES RESTAURANT	6043 sf

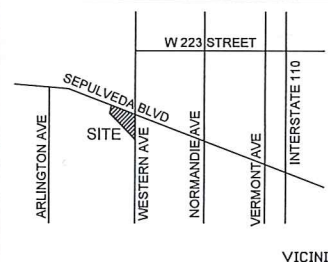
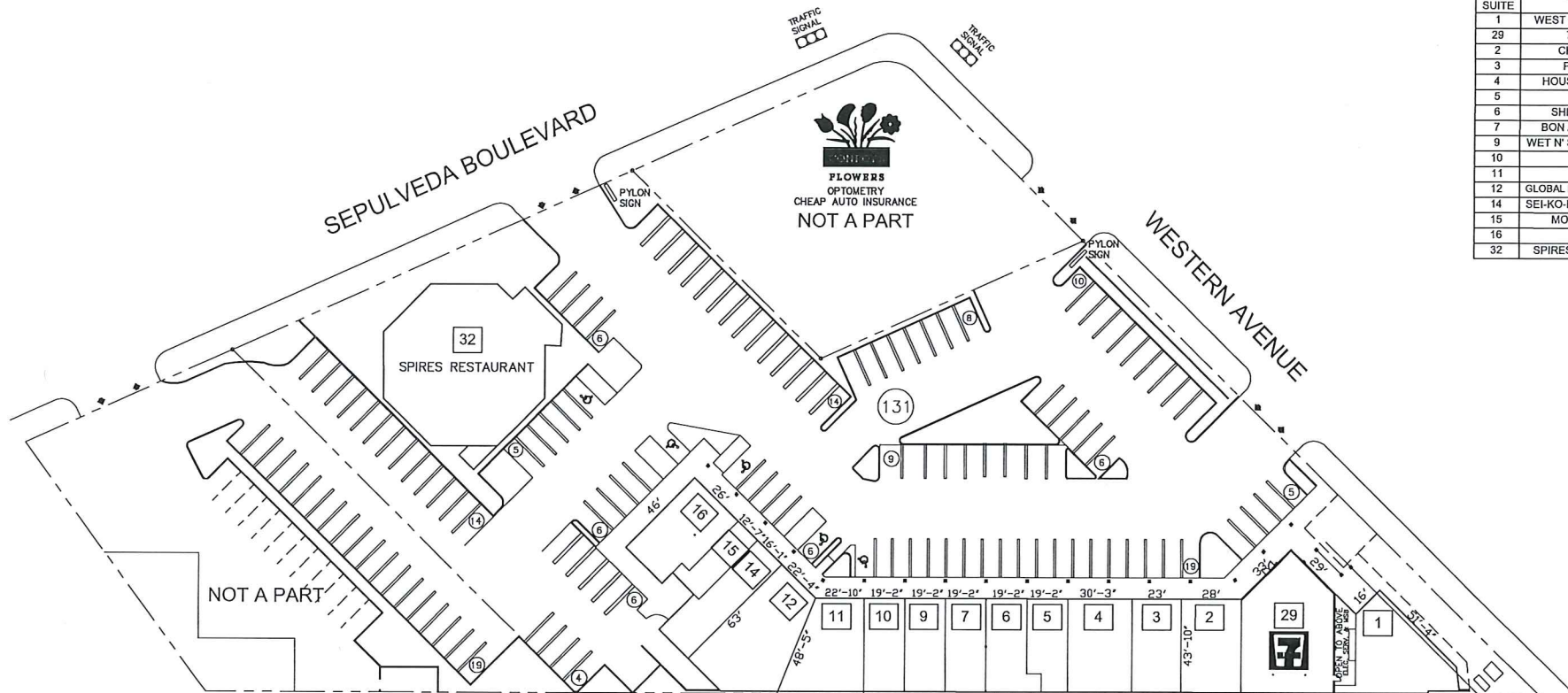

TOTAL BUILDING SF:	22,914 SF
PARKING PROVIDED:	131 STALLS
PARKING RATIO:	5.73/1000 SF
TRAFFIC COUNTS:	114,000 ADT (2005)
DEMOGRAPHICS	1 MILES 3 MILES 5 MILES
2018 EST. POP.	32,672 223,187 528,827
2023 PROJ. POP.	34,506 229,743 540,955
AVG. HH. INCOME	96,258 96,853 109,087

DISCLAIMER: THIS PLAN IS PROVIDED SUBJECT TO (I) ERRORS AND OMISSIONS IN THE INFORMATION AND (II) MODIFICATION WITHOUT NOTICE. THE INFORMATION, SPECIFICATIONS, DIMENSIONS AND/OR TABULATIONS SET FORTH IN THIS PLAN HAVE BEEN DERIVED FROM DOCUMENTS BELIEVED TO BE RELIABLE. HOWEVER, THIS PLAN MAY BE INCOMPLETE AND/OR INACCURATE. NO REPRESENTATION OR WARRANTY, EXPRESSED OR IMPLIED AS TO THE ACCURACY OR ADEQUACY REGARDING SUCH INFORMATION IS MADE BY THE OWNER OF THE PROJECT, PROPERTY MANAGER OR ANY OTHER RESPECTIVE PARTNERS, DIRECTORS, OFFICERS, EMPLOYEES AND AGENTS. NONE OF THE FOREGOING PARTIES SHALL HAVE ANY LIABILITY FOR SUCH ERRORS, OMISSIONS, INCOMPLETENESS OR INACCURACIES. ANY PERSON OR ENTITY REVIEWING THIS PLAN SHOULD MAKE THEIR OWN INDEPENDENT INVESTIGATION OF THE INFORMATION CONTAINED HEREIN.

WESTERN TOWN PLAZA
1730 W SEPULVEDA BOULEVARD TORRANCE, CA 90501

SITE LEASE PLAN

WATT COMPANIES
2716 OCEAN PARK BOULEVARD
SANTA MONICA, CA 90405
T. 310.314.2430

SCALE: 0' 25' 50'
Mar. 11, 19
S
SHEET 1 OF 1