

W CARSON STREET

TRAFFIC SIGNAL

MAIN STREET

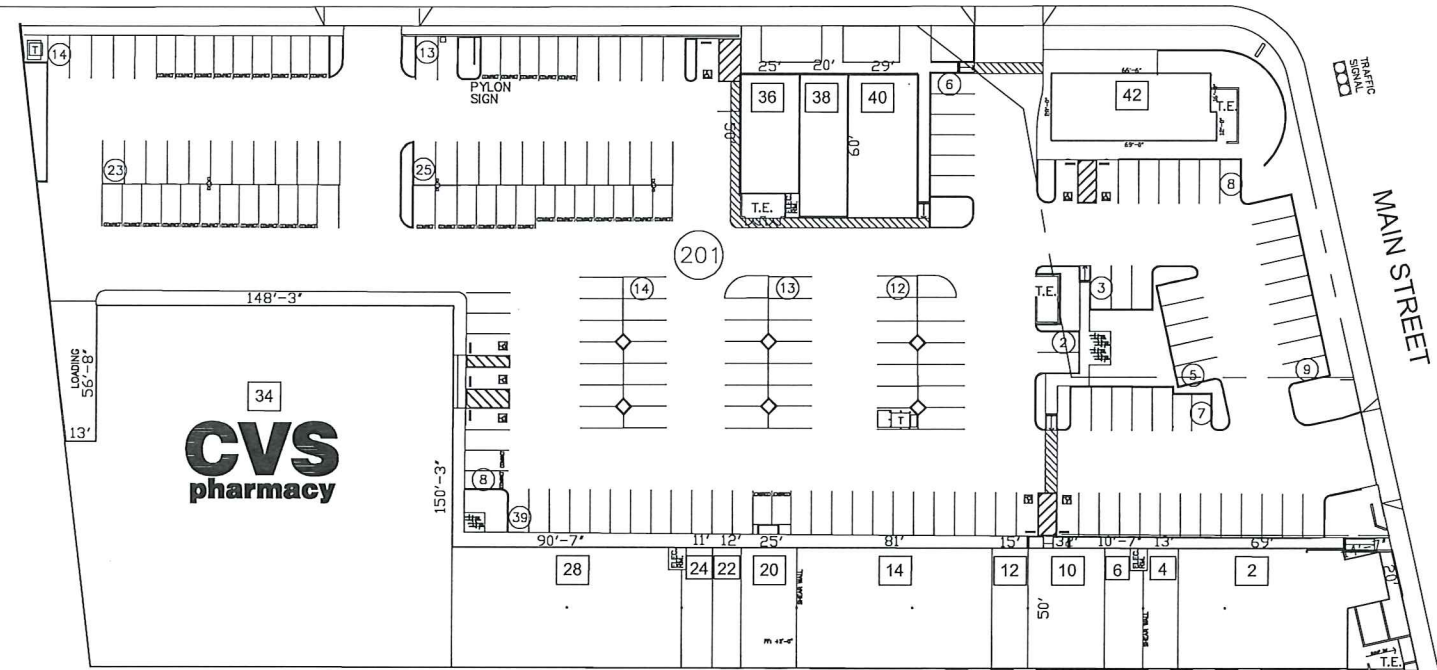

TENANT LEGEND		
SUITE	TENANT	SF
2	GOLDLOCKS	3936 sf
4	PATRICK'S WATCHES	580 sf
6	JOLLY B. EXPRESS	695 sf
10	MANILA LECHON REST	1600 sf
12	JOY BAKERY	750 sf
14	TAMBULI MARKET	4050 sf
20	H & R BLOCK	1250 sf
22	LEWIS CLEANERS	550 sf
24	HERBAL TOUCH	600 sf
28	DAVITA MEDICAL MGMT	3450 sf
34	CVS	22,851 sf
36	POPEYES	1250 sf
38	CHOW FUN	1200 sf
40	MABUHAY BANKING	1800 sf
42	BLUE LOTUS	1848 sf

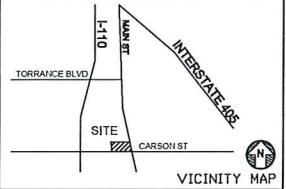

TOTAL BUILDING SF:	47,710 SF
PARKING PROVIDED:	201 STALLS
PARKING RATIO:	4.2/1000 SF
TRAFFIC COUNTS:	53,820 ADT (2007)
DEMOGRAPHICS	1 MILES 3 MILES 5 MILES
2018 EST. POP.	36,825 190,652 506,214
2023 PROJ. POP.	38,970 196,888 518,295
AVG. HH. INCOME	91,722 91,453 88,003

DISCLAIMER: THIS PLAN IS PROVIDED SUBJECT TO (i) ERRORS AND OMISSIONS IN THE INFORMATION AND (ii) MODIFICATION WITHOUT NOTICE. THE INFORMATION, SPECIFICATIONS, DIMENSIONS AND/OR TABULATIONS SET FORTH IN THIS PLAN HAVE BEEN DERIVED FROM DOCUMENTS BELIEVED TO BE RELIABLE. HOWEVER, THIS PLAN MAY BE INCOMPLETE AND/OR INACCURATE. NO REPRESENTATION OR WARRANTY, EXPRESSED OR IMPLIED AS TO THE ACCURACY OR ADEQUACY REGARDING SUCH INFORMATION IS MADE BY THE OWNER OF THE PROJECT, PROPERTY MANAGER OR ANY OTHER RESPECTIVE PARTNERS, DIRECTORS, OFFICERS, EMPLOYEES AND AGENTS. NONE OF THE FOREGOING PARTIES SHALL HAVE ANY LIABILITY FOR SUCH ERRORS, OMISSIONS, INCOMPLETENESS OR INACCURACIES. ANY PERSON OR ENTITY REVIEWING THIS PLAN SHOULD MAKE THEIR OWN INDEPENDENT INVESTIGATION OF THE INFORMATION CONTAINED HEREIN.

**CARSON SHOPPING CENTER**  
 100-154 W CARSON STREET CARSON, CA 90745  
**SITE LEASE PLAN**

**WATT COMPANIES**  
 2716 OCEAN PARK BOULEVARD  
 SANTA MONICA, CA 90405  
 T. 310.314.2430

SCALE: 0' 25' 50'  
 Mar. 10, 19  
 SHEET 1 OF 1