

# CANYON COUNTRY VILLAGE

NEC SOLEDAD CANYON ROAD & WHITES CANYON ROAD | CANYON COUNTRY, CALIFORNIA

## Available Space:

1,250sf

2,000sf

## For leasing information, contact:

Karin Gilbert  
(310) 314-2466  
kgilbert@wattcompanies.com

DRE License #01857327

Watt Companies, Inc.  
2716 Ocean Park Blvd.  
#3040  
Santa Monica, CA 90405

(888) 310-WATT  
(310) 314-2430  
www.wattcompanies.com



## PROPERTY DETAILS:

- Located near the highly trafficked intersection of Soledad Canyon and Sierra Highway
- Close proximity to the 14 Freeway
- High income trade area

## DEMOGRAPHIC HIGHLIGHTS:

Estimates	1 Mile	3 Miles	5 Miles
Population	19,896	69,751	165,160
Average Household Income	\$80,771	\$93,843	\$103,691

Source: Claritas 2009

## TRAFFIC COUNTS:

Intersection	Cars Per Day
Soledad Canyon & Whites Canyon	70,000

Source: City of Santa Clarita, 2005

Owned and Managed by:



The information herein has been secured from sources we believe to be reliable; however, Watt Companies makes no guarantees, warranties or representations as to the completeness or accuracy thereof. The presentation of this property is submitted subject to errors, omissions, changes of price or conditions prior to the sale or lease, or withdrawal without notice.

# CANYON COUNTRY VILLAGE

NEC SOLEDAD CANYON ROAD & WHITES CANYON ROAD | CANYON COUNTRY, CALIFORNIA

## Available Space:

1,250sf

2,000sf

For leasing information,  
contact:

Karin Gilbert  
(310) 314-2466  
kgilbert@wattcompanies.com

DRE License #01857327

Watt Companies, Inc.  
2716 Ocean Park Blvd.

#3040

Santa Monica, CA 90405

(888) 310-WATT

(310) 314-2430

www.wattcompanies.com

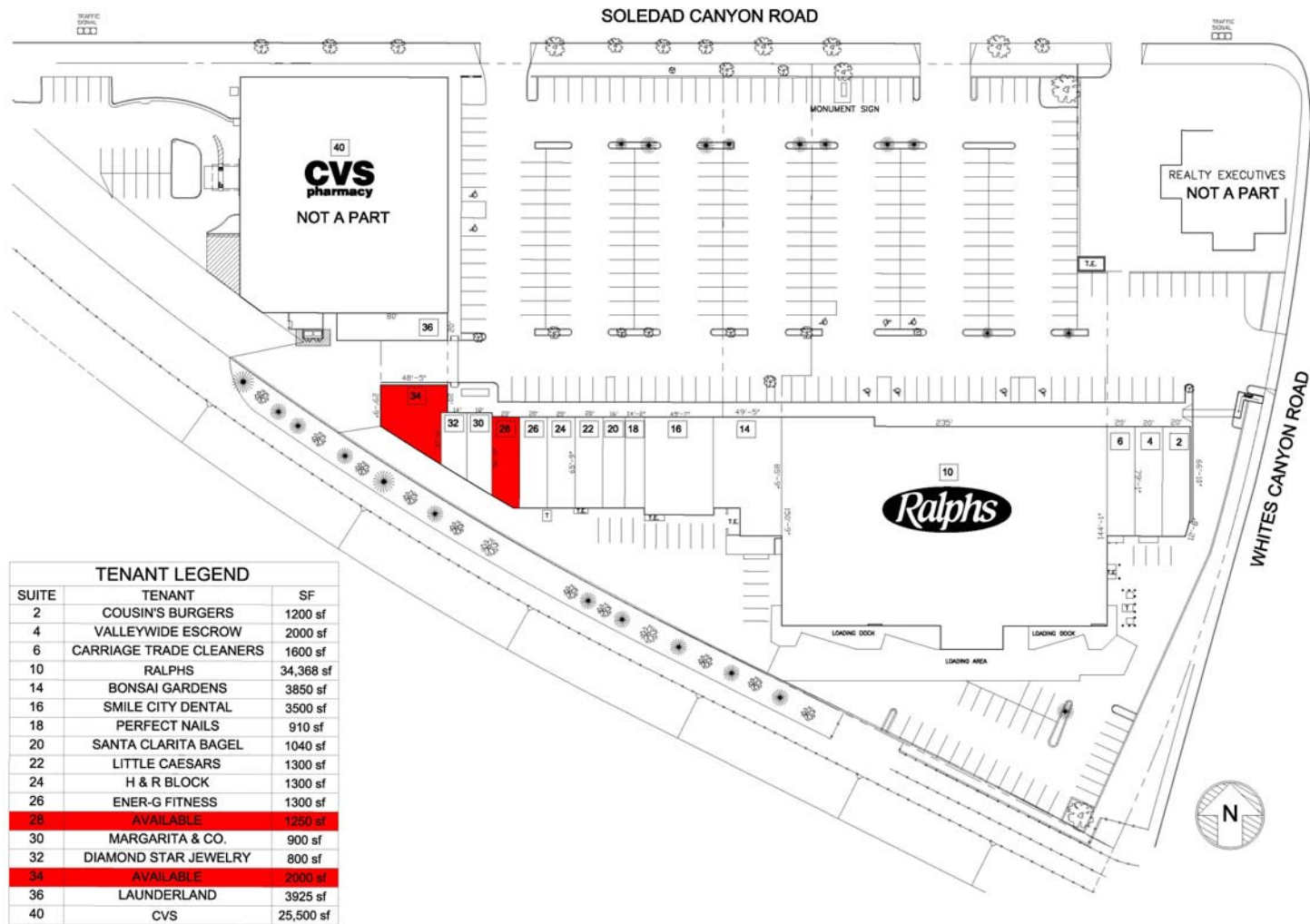

## JOIN THESE RETAILERS:



Owned and Managed by:

The information herein has been secured from sources we believe to be reliable; however, Watt Companies makes no guarantees, warranties or representations as to the completeness or accuracy thereof. The presentation of this property is submitted subject to errors, omissions, changes of price or conditions prior to the sale or lease, or withdrawal without notice.